

REVISION RECORD

DWG STATUS: _____		CHG NO.: _____		REV: _____	
REV/TYPE	CHG BY/DATE	CHG BY/DATE	CHK CODE	CHG NO.	CHK

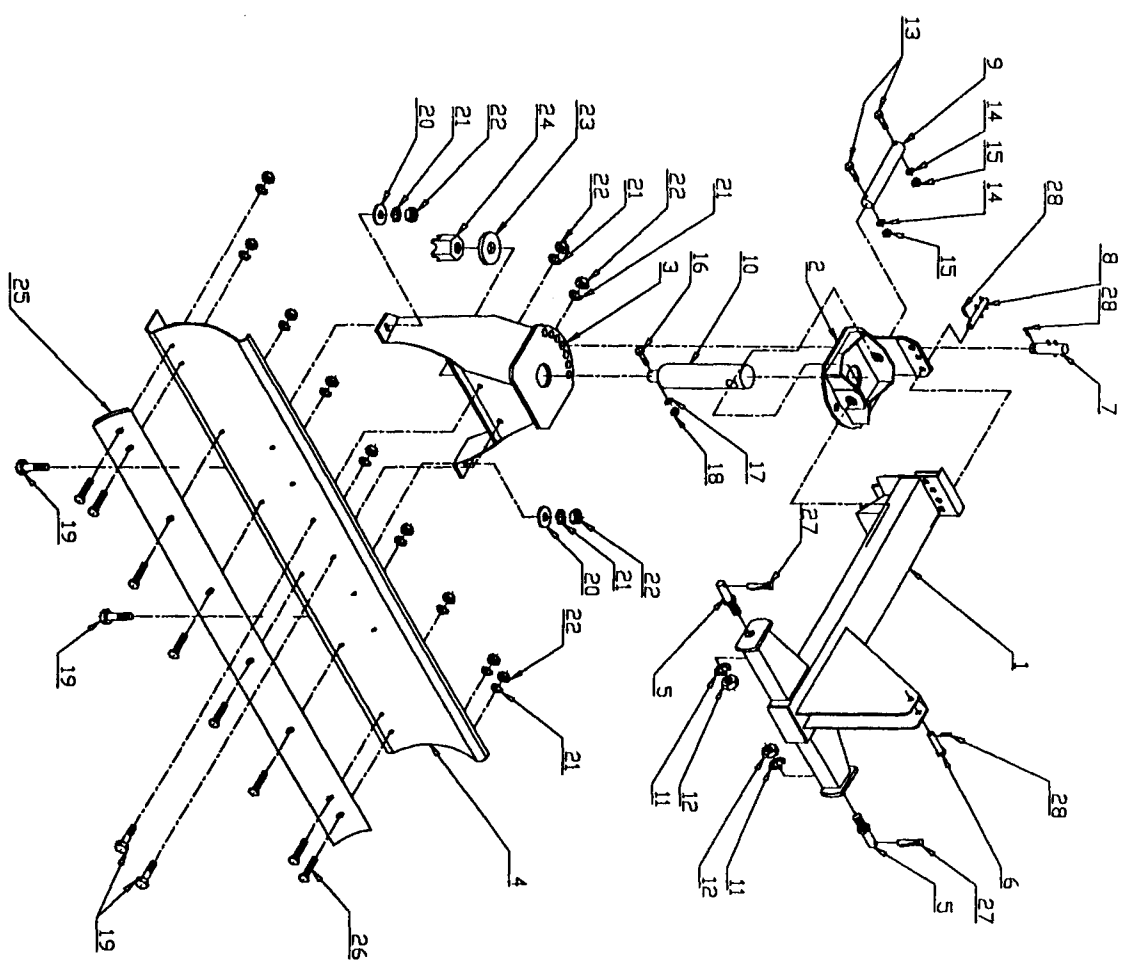

ITEM	PART NO.	DESCRIPTION	QTY
1	-	3 POINT-MAIN FRAME	1
2	-	TURN TABLE	1
3	-	OFFSET PLATE-ASSEMBLY	1
4	-	MOLDBOARD 6 FT	1
5	-	LOWER HITCH PIN	2
6	-	UPPER HITCH PIN	1
7	-	ANGLE PIN	1
8	-	PIVOT PIN	1
9	-	PIVOT PIN	1
10	-	KING PIN	1
11	-	1" LOCK WASHER	2
12	-	1 - 8 UNC NUT	2
13	-	3/8 - 16 UNC x 2 BOLT	2
14	-	3/8 LOCK WASHER	2
15	-	3/8 - 16 UNC NUT	2
16	-	5/16 - 18 UNC x 2-1/2 BOLT	1
17	-	5/16 LOCK WASHER	1
18	-	5/16 - 18 UNC NUT	1
19	-	5/8 - 11 UNC x 1-1/2 BOLT Gds. 5	4
20	-	5/8 FLAT WASHER	2
21	-	5/8 LOCK WASHER	12
22	-	5/8 - 11 UNC NUT	12
23	-	KING PIN CAP	1
24	-	1-1/2 - 12 UNF HEX SLOTTED NUT	1
25	-	CUTTING EDGE 6 FT	1
26	-	5/8 - 11 UNC x 2 Round Head Short Square Neck Bolt Gds. 5	8
27	-	7/16 LOCK PIN	2
28	-	1/8 "R" COTTER PIN	3
-	-	-	-
-	-	-	-

VH Technomec

SOLD BY C.V.

THESE DRAWINGS AND SPECIFICATIONS AND THE DATA CONTAINED THEREIN, ARE EXCLUSIVE PROPERTY OF TECHNOMEC S.A. DE C.V. AND ARE TO BE USED ONLY FOR THE MANUFACTURE OF THE PARTS AND ASSEMBLIES SPECIFIED HEREIN. NO PARTS OR ASSEMBLIES SHALL BE MANUFACTURED OR USED FOR ANY OTHER PURPOSE WITHOUT THE WRITTEN PERMISSION OF TECHNOMEC S.A. DE C.V. ANY VIOLATION OF THIS AGREEMENT SHALL BE CONSIDERED A BREACH OF CONTRACT AND SHALL BE SUBJECT TO LEGAL ACTION.

UNLESS OTHERWISE SPECIFIED:

TECHNOMEC MATERIAL SPECIFICATIONS

PRODUCT: **NVH-180-T**

RELATED SPECIFICATIONS: _____

DIMENSIONS IN: INCHES MILLIMETERS

REFER TO FOR DRAWING INTERPRETATION:

THIRD ANGLE PROJECTION

MAXIMUM SURFACE TEXTURE

UNTOLERANCED DIMENSIONS OVER TO TOLERANCE	TOLERANCE	APPROVAL SIGNATURES	DATE	SCALE
	± .	DESIGNED BY: _____		
	± .	DRAWN BY: _____		
	± .	APPROVED BY: _____		

APPROVED BY: INC. JOSE LEONCIO VALDES R. 14/11/97 DO NOT SCALE PRINT

DESCRIPTION: _____

DWG NUM: **A4** QTY: **1**

REF DWG: _____

PART NO: **NVH180T**

DESCRIPTION: **NVH180T**

QTY: **1**